

AEROLITE ECO

"Proven technology with multi-optic solutions"

- high speed and urban roads • bicycle lanes • parks and walking paths •
- parking areas • industrial areas •



- More than 11 optic pattern
- I-nfinity MK2™ 2020 driver technology
- Ultra slim Bionic housing design
- High wind resistance
- Guaranteed lifetime quality

STREET

GRAH®
LED LIGHTING

AEROLITE ECO S



AEROLITE ECO M



AEROLITE ECO L



TECHNICAL SPECIFICATIONS

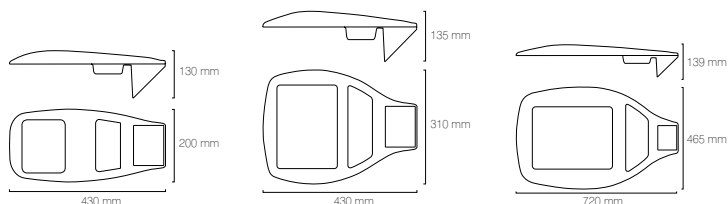

AEROLITE ECO S

AEROLITE ECO M

AEROLITE ECO L

Supply voltage range:	190-264 V, 50 / 60 Hz		
Surge protection:	4 kV		
Consumption:	13 W / 37 W	49 W / 89 W	92 W / 185 W
Power Factor:	> 0,9		
Temperature range:	-30 °C / +60 °C		
Working temperature at Ta25:	+55 °C		
LEDs overheating protection:	NTC thermistor		
Light guiding system:	PMMA lenses		
Optics:	Asymmetric		
Power reduction:	50% step DIM, 1-10 V and Astro DIM		
Light source:	High power LED		
Colour temperature:	4000 K (3000 K, 5000 K on request)		
Colour Rendering Index:	CRI > 70		
LED Lifetime:	> 100.000 hours, L90B10 @ Ta = 25 °C		
System efficacy:	up to 138 lm/W	up to 127 lm/W	up to 138 lm/W
Luminous flux:	1.800 lm / 4.500 lm	6.200 lm / 10.700 lm	12.700 lm / 23.900 lm
Appliance class:	I or II		
Housing material:	Aluminium alloy		
Sealing material:	Silicone, heat resistant		
Cover material:	PMMA		
Housing colour:	Grey (RAL9006) (other colours on request)		
Wind resistance:	0,023 m ²	0,024 m ²	0,043 m ²
Ingress protection class:	IP66		
Impact resistance:	IK09 / IK10		
Design:	Shape for best heat conductivity and water flow		
Mounting angle adjustment:	+/- 15°		
Mounting diameter option:	Ø60 and Ø76		
Suggested mounting height:	3-6 m	6-10 m	10-15 m
Dimension (L x W x H):	430 x 200 x 130 mm	430 x 310 x 135 mm	720 x 465 x 139 mm
Net weight:	2,5 kg	3,5 kg	6,8 kg



COMMERCIAL SPECIFICATIONS

ID : 1 1 7 1 - 0 0 1 8 - 1 2 3 4 - 6 4 1 1 - 0 0 0 0

Code	Name	Code	Regulat.	Code	Optics / Lum. fl. [lm]	Power [W]	Code	App. class	Code	Colour Temp. [K]	Code	Hous. Colour	Code	Size		
1171	AEROLITE ECO	018			20 DWC	13										
		022			21 A-T	17										
		029			23 FN	24								1	S	
		034			24 DNW	25										
		045			25 SCL	26 ME	37									
		062	0 ON/OFF		27 ME-Wide 1	28 T2	49									
		072	1 1-10 V		29 PX-R	29 PX-R	59	1	SCI	3	3000*	1	Grey	2	M	
		092	2 50% step DIM		41 PX-L	41 PX-L	74	2	SCII	4	4000	6	Special			
		107	D Astro DIM		51 T4	51 T4	89			5	5000*					
		127					92									
		147					111									
		167					123									
		193					148								3	L
		207					153									
		239					185									

*Luminous flux for 3000 K and 5000 K may vary, please contact our Sales department for detailed information.
Choose your bracket from the accessories.

Code	Options accessories
0013	Nema Socket 7
0002	iMCU*

*For luminaires with iMCU 1-10V regulation is required

FEATURES

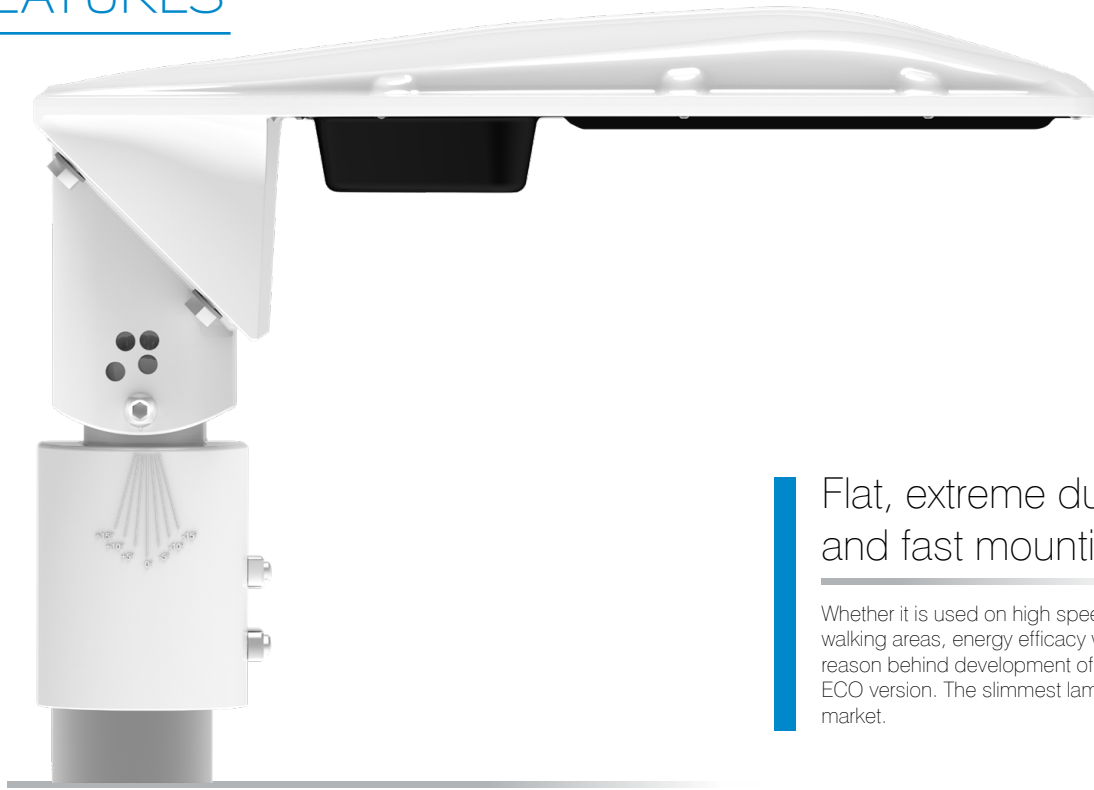

Flat, extreme durability and fast mounting

Whether it is used on high speed roads or in walking areas, energy efficacy was the main reason behind development of the Aerolite ECO version. The slimmest lamps on the market.

3 sizes with 11 light distributions

New optics systems for 11 different applications. Aerolite ECO comes with 4 kV surge protection against internal components damage. With the latest LED chip, efficacy is increased up to 138 lm/W. NTC thermistor is used to protect the LEDs from overheating.

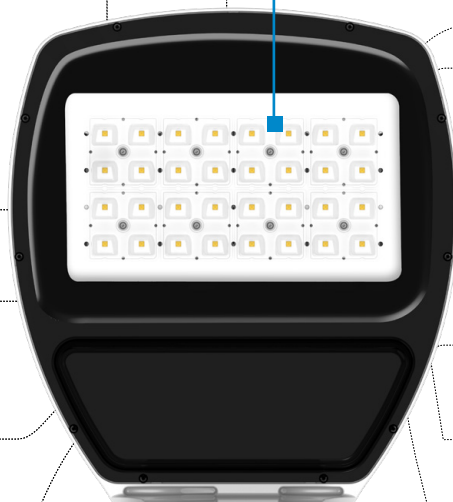
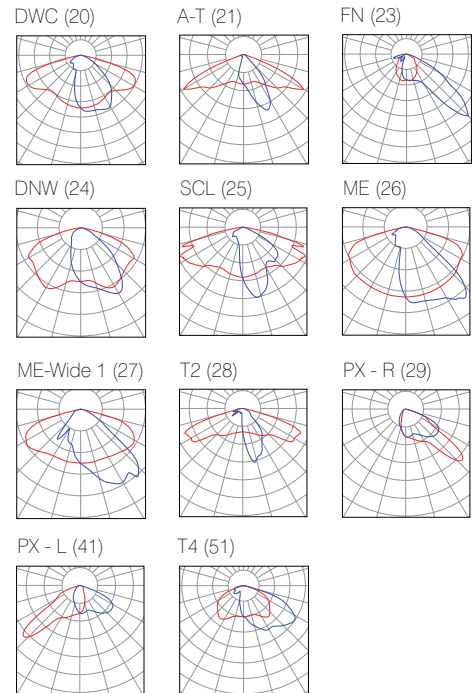

TIP: for detailed information on light distributions and the connection with pole height, distance between poles and road width see brochure: **Street LED Lighting Guidelines**

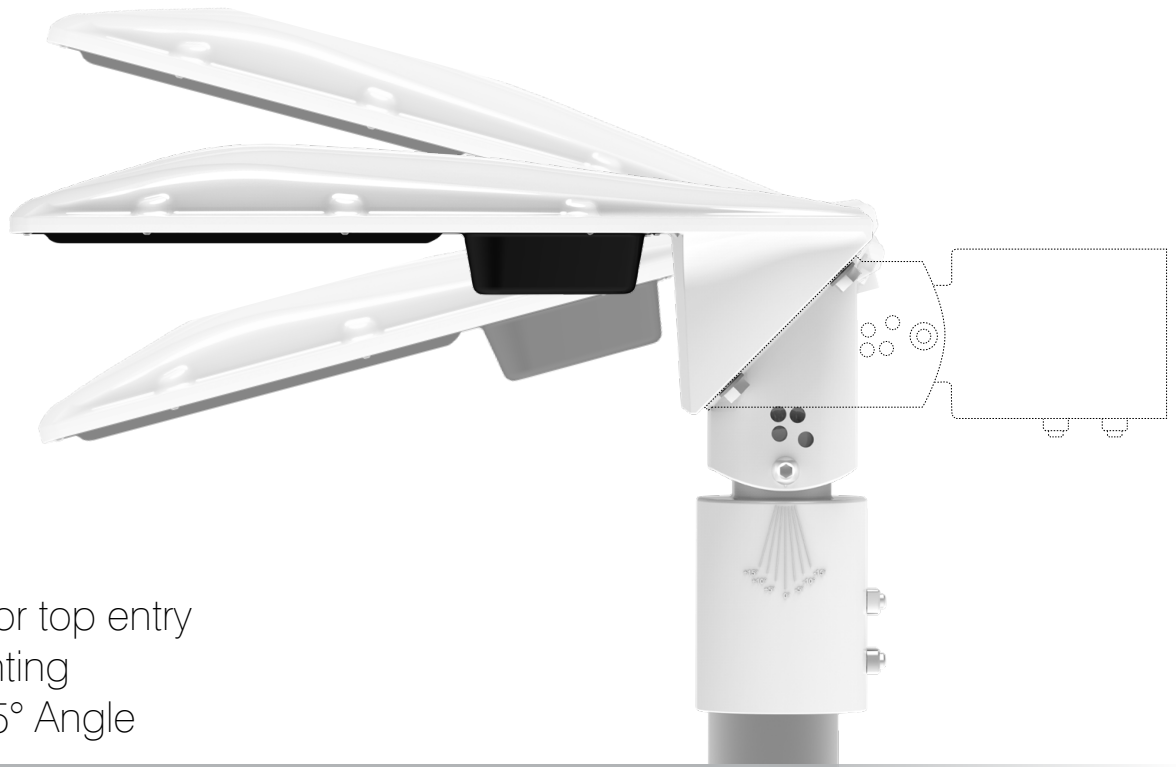

Side or top entry
mounting
+/-15° Angle

Three different bracket types with different angle settings.
Fix bracket up to Ø60 mm pole and up to Ø76 mm when adjustable.
Adapter for Ø60 mm to Ø40 mm available.

TIP: for other mountings options and extensions see next page



With luminous flux from 1.800 lm to 23.900 lm and different optics systems, Aerolite ECO cover all your needs

- smaller roads
- residential streets
- private driveways
- walking paths
- bicycle lanes
- side ways
- pedestrian crossings
- parking lots
- industrial areas
- interurban roads
- urban roads
- high speed traffic roads
- junctions
- resting places
- collector roads

ACCESSORIES FOR STREET LIGHTS

COLOURS

You can choose one of the three colour options for your accessory.

Accessories Colours

0	Not Painted	1	Grey Colour	6	Special Colour
---	-------------	---	-------------	---	----------------

Replace (z) in Accessories Code with selected colour from the table above.

BRACKETS

Our AEROLITE LSL & ECO street lights come without brackets - you must choose one of the brackets below.



Accessories	Bracket Adjustable Aerolite Ø60
--------------------	---------------------------------

Code	3999-0016-0000-00z0
-------------	---------------------

Accessories	Bracket Adjustable Aerolite Ø76
--------------------	---------------------------------

Code	3999-0017-0000-00z0
-------------	---------------------

Accessories	Bracket Fix Aerolite Ø60
--------------------	--------------------------

Code	3999-0018-0000-00z0
-------------	---------------------

Replace (z) in Accessories Code with selected colour from the table above.

CONTROL UNITS & PROTECTION

Aerolite luminaires can be upgraded with:

Code	Accessories
3999-0003-0000-0000	iMCU* - intelligent control unit
3999-0004-0000-0000	10kA Surge Protection Module Class I self turn off
3999-0005-0000-0000	10kA Surge Protection Module Class II self turn off
3999-0006-0000-0000	Timer control unit 50% dimming (single step)
3999-0007-0000-0000	Timer control unit 1 - 10 V dimming (analog)

*For luminaires with iMCU 1-10V regulation is required

SERVICE KIT

Our AEROLITE LSL & ECO street lights are built to last long, depending on climate region it is necessary to change the light gasket.



Accessories	Service KIT Aerolite
--------------------	----------------------

Code	3999-0014-0000-0000
-------------	---------------------

REDUCTION AND EXTENSION OPTIONS

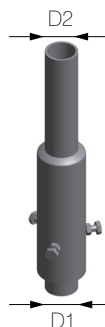
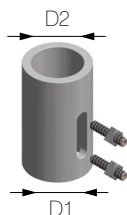

Accessories	Reduction adapter	D1 [mm]	D2 [mm]	Pole reduction	D1 [mm]	D2 [mm]	Z [mm]	Pole extension	D1 [mm]	D2 [mm]	Z [mm]
Code	3999-0015-0000-0000	60	40	3999-0027-0000-00z0	76	60	520	3999-0028-0000-00z0	60	60	1000
								3999-0029-0000-00z0	76	60	1000

MOUNTING OPTIONS

Different situations require different mounting options. Below information explains and represents different basic mounting option solutions.

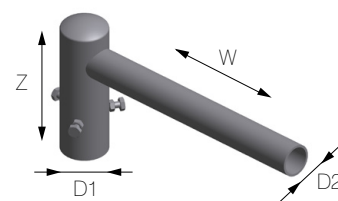
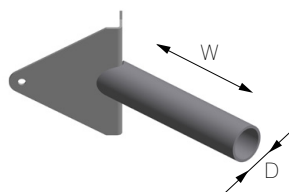
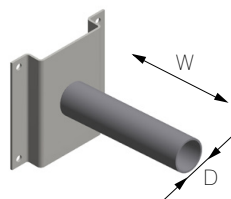

Accessories	Wall boom	W [mm]	D [mm]	Wall corner boom	W [mm]	D [mm]	Pole single boom extension	W [mm]	D1 [mm]	D2 [mm]	Z [mm]
Code	3999-0046-0000-00z0	300	60	3999-0045-0000-00z0	300	60	3999-0019-0000-00z0	500	60	60	150
							3999-0020-0000-00z0	500	76	60	200

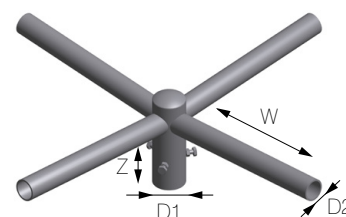
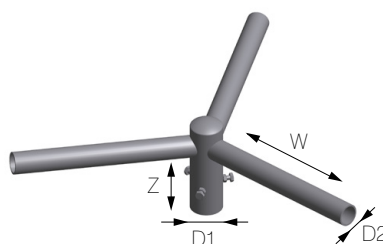
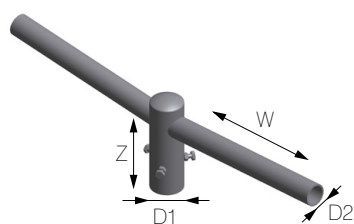

Accessories	Pole double boom extension	W [mm]	D1 [mm]	D2 [mm]	Z [mm]	Pole triple boom extension	W [mm]	D1 [mm]	D2 [mm]	Z [mm]	Pole quad boom extension	W [mm]	D1 [mm]	D2 [mm]	Z [mm]
Code	3999-0021-0000-00z0	500	60	60	150	3999-0023-0000-00z0	500	76	60	150	3999-0025-0000-00z0	500	76	60	150
	3999-0022-0000-00z0	500	76	60	200	3999-0024-0000-00z0	1000	76	60	200	3999-0026-0000-00z0	1000	76	60	200

TIP: the list includes the most frequently used mounting adapter options. There are more options possible considering different diameter and length

For more data or requirements please contact our Sales department.



GRAH LIGHTING d.o.o.
Zadružna ulica 6,
SI-2310 Slovenska Bistrica,
Slovenia, EU

+386 82 801 424
info@grahlighting.com
www.grahlighting.com